



Tow Tractor

620 PF-T **ac** 620 PM-T **ac**



The new tow tractors Model 620 PF-T ac and 620 PM-T ac are used to tow different trailers up to 3.000 kg. This allows a flexible material turnover and time and costs saving. They are available with manual couplings with different positions so they can adapt to any type of trailer. The coupling is wide visible from any position and easily accessible. The PM-T version with operator's platform and controls lifting at 1.200 mm is suitable for towing and order-picking duties.

Electronic system

The units are equipped with ac devices able to work in high temperature conditions (on the control and/or on the motor) without any unit stops. The units are equipped with controllers which check and control all the functions and allow many adjustments to optimise the units performances, adapting it to the type of work application it has to carry out. All the parameters related to drive, steering and braking are electronically adjustable by a programming console in accordance with the customers requirements.

Drive

Reliable sensor less three phase current traction drive motor ac able to meet the most demanding performance requirements, delivering the necessary power under all load conditions as the traction speed exactly depends on the position of the drive throttle.

Braking system

There are three braking systems in the range:

- braking on reversal of direction of travel with energy recovery by regenerative braking (service braking);
- emergency braking which occurs automatically on release of the dead-man pedal;
- parking brake with releasing of the dead man pedal.

| | | | | | | |
|---------------------------------------------------|------|------------------------------------------------------|-------|-------|-----------------|-------------|
| Characteristics | 1.1 | Manufacturer | | | OMG S.r.l. | |
| | 1.2 | Model | | | 620 PF-T ac | 620 PM-T ac |
| | 1.3 | Drive | | | electric | |
| | 1.4 | Operator type | | | stand-on | |
| | 1.5 | Load capacity / rated load | Q | t | 3.0 | |
| | 1.7 | Rated tractive force | | daN | 250 | |
| | 1.9 | Wheelbase | y | mm | 1.018 | |
| Weights | 2.1 | Service weight incl. battery (see line 6.5) | | kg | 1.070 | |
| | 2.3 | Axle loading, unladen front/rear | | kg | 850 / 220 | |
| Wheels Chassis | 3.1 | Tires | | | polyurethane | |
| | 3.2 | Tire size, front | | mm | 245 - 125 | |
| | 3.3 | Tire size, rear | | mm | 150 x 80 | |
| | 3.4 | Additional wheels dimensions | | mm | 150 | |
| | 3.5 | Wheels, number front / rear (x = driven wheels) | | | 2 - 1x / 4 | |
| | 3.7 | Track width, rear | b11 | mm | 696 | |
| Basic dimensions | 4.8 | Seat height / platform height | h7 | mm | 1.200 | |
| | 4.9 | Height of tiller arm in drive position min. / max. | h14 | mm | 1.330 | |
| | 4.19 | Overall length | l1 | mm | 1.496** | |
| | 4.21 | Overall width | b1/b2 | mm | 804 / 808 | |
| | 4.32 | Ground clearance, centre of wheelbase | m2 | mm | 20 | |
| | 4.35 | Turning radius | Wa | mm | 1.260 | |
| Performances | 5.1 | Travel speed laden / unladen | | km/h | 7 / 12 | |
| | 5.5 | Drawbar pull with / without load | | N | | |
| | 5.6 | Max drawbar pull with / without load | | daN | 400 | |
| | 5.10 | Service brake | | | electromagnetic | |
| Electric Motor | 6.1 | Traction motor, rating S2 60 min | | kW | 2.6 | |
| | 6.2 | Lift motor, rating S3 15% | | kW | / | 2 |
| | 6.3 | Battery according to DIN 43531 / 35 / 36 A, B, C, no | | | | |
| | 6.4 | Battery voltage, nominal capacity K5 | | V/Ah | 24 / 375 - 465* | |
| | 6.5 | Battery weight | | kg | 300 - 360* | |
| | 6.6 | Energy consumption according to VDI cycle | | kW/h | 0.74 | |
| Others | 8.1 | Type of drive control | | | ac | |
| | 8.4 | Sound level at driver's ear according to EN 12 053 | | dB(A) | < 70 | |
| ** the L1 change in accordance with the hook type | | | | | * option | |

Technical specification according to VDI 2198, technical values are referred to the standard product. Different masts, different tires, additional equipment, etc. could produce other values. Information and data are given for information only, OMG S.r.l. will have the sole right for technical changes and improvements without giving any notice.

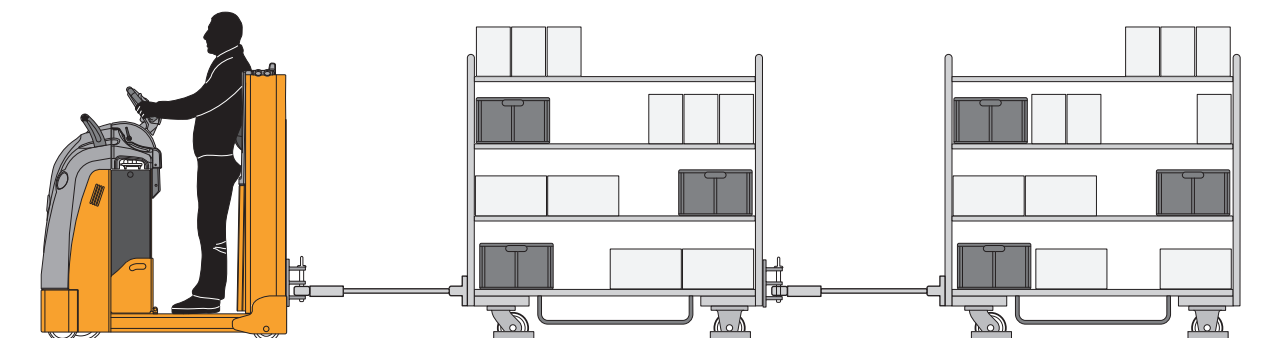
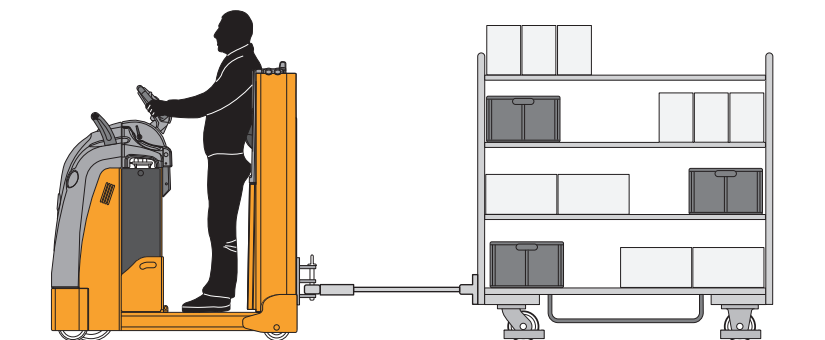

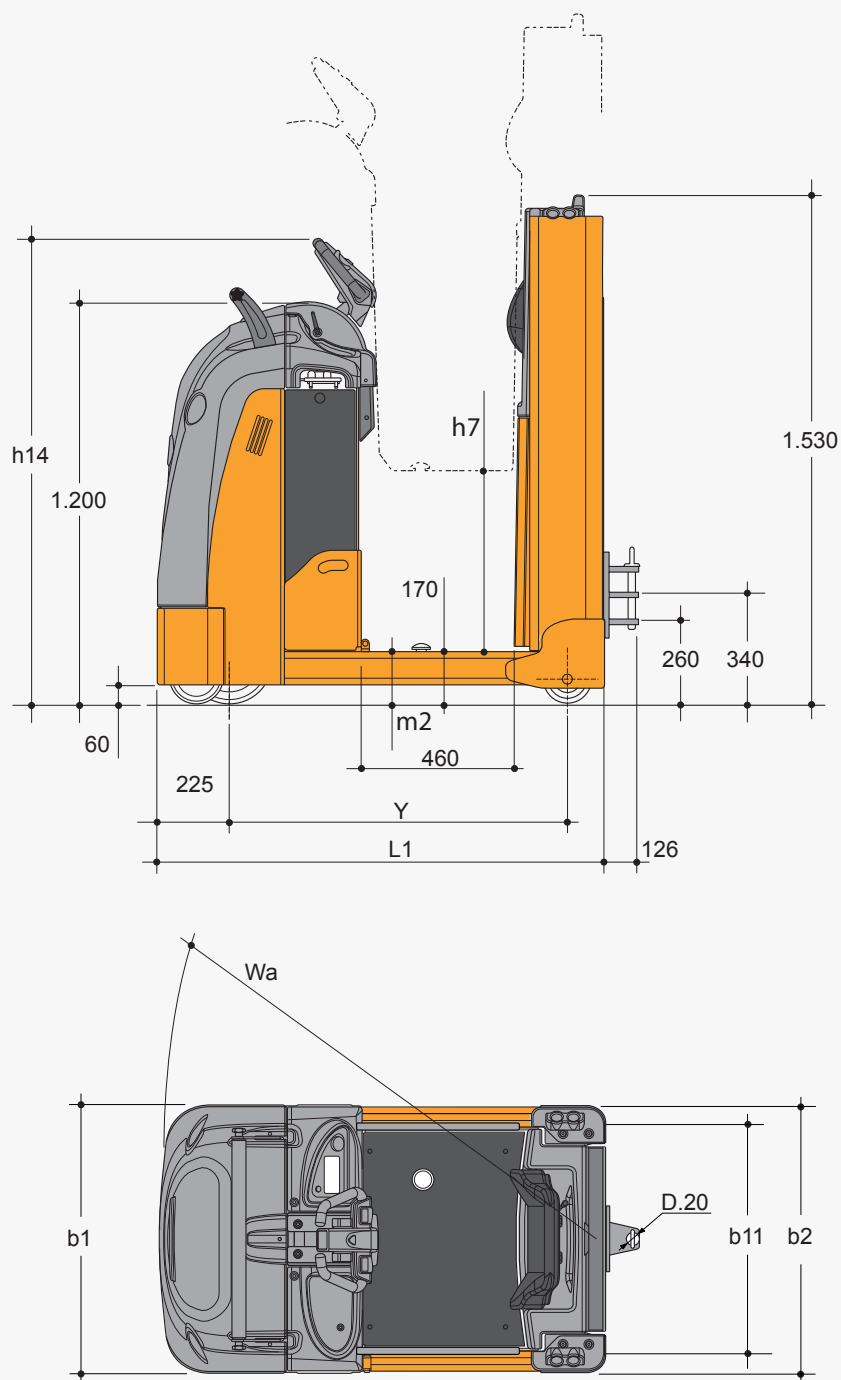

Options and special executions available

| | | | |
|----------------------------------------------------------|--|-------------------------------------------------------------|--|
| adjustable "cloche" electric servo steering | | front lamps | |
| battery side extraction facility | | forward/reverse "pulse" push button on back rest (backing) | |
| single battery stand & double battery stand with wheels | | electronic speed control | |
| support bar for electronic devices and other accessories | | traction speed 12 km/h, automatic speed reduction on corner | |
| plastic film reel holder | | cold store execution | |
| paper holder A4 format | | electromagnetic parking brake | |
| bar code reader support / holder | | BDI/hour meter with lifting cut-off at 80% discharge | |
| power output for electronic devices | | pin access keypad | |

standard

option



Comfort driving

The central position of the operator, within the chassis ensure a high level of protection and a wide view visibility. Cushioned comfort operator's platform with dead-man switch. The operator will not suffer a frequent in and out from the unit thanks to the reduced height of the entry step (170 mm only). For an easy and comfortable controlling of the truck the operating functions are easy reachable without moving the hands from the steering. Light steering with only a 80° degree adjustable "cloche" electric servo steering required for a 180° steering direction change. No twisting of the operator body when travelling through curves.

The lifting of the operator's platform and the controls up to 1.200 mm from the ground (model 620 PM-T ac) allow to reach a picking height of 2.800 mm. Platform lifting is electronically managed in order to avoid jolts.

The forward / reverse "pulse" push button placed on both sides of the back rest, backing (option), will allow the horizontal traction movements for pedestrian operations.



OMG S.r.l.

Legal Seat:

Corso Buenos Aires, 18 - 20124 Milano

Seat:

Via dell'Artigianato, 12 - 46023 Gonzaga (MN) Italy Tel. +39 0376 526011 Fax +39 0376 588008

www.omgindustry.com - info@omgindustry.com

